

## Wireless USB Adapter

Images may differ from your actual product  
©2023 MERCUSYS 7107500301 REV1.2.0

# 1 Connect to a Computer

## Option 1: Directly

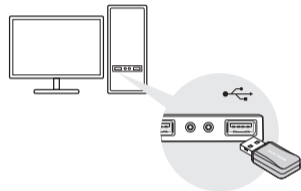

## Option 2: Via the USB Extension Cable (If provided)

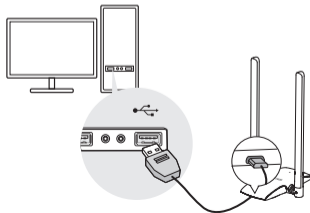

# 2 Install Driver

Follow **Method 1** if the adapter supports Plug and Play feature. If not, please try **Method 2**.

## Method 1: Plug and Play

- This adapter supports **Plug and Play** feature. Plug the adapter in and then it is ready to use.
- If your operating system does not support this feature, follow the steps below:
  - a. Download the driver or check the new release at [www.mercusys.com/support](http://www.mercusys.com/support).
  - b. Unzip the downloaded folder and run the Setup.exe.
  - c. Follow the instructions to complete the installation.

### Tips:

- If you can't install the driver successfully, disable the antivirus software and firewall, then try again.
- If an unknown publisher message pops up, select Yes to continue.
- If Windows User Account Control requires admin credentials, type user name and password of your Windows administrator account.

For more driver installation support, refer to **Troubleshooting > T2**.

## Method 2: via Internal Driver Installation

- a. Go to **My Computer** or **This PC**.
- b. Find out **Mercusys** disk then run the **SetupInstall.exe** to start driver installation.  
**Note:**  
If you cannot find the Mercusys disk, download the driver at [www.mercusys.com/support](http://www.mercusys.com/support).
- c. Follow the instructions to complete the installation.

## 3 Join a Wireless Network

a. Click the network icon (  ) on the taskbar.

b. Select your Wi-Fi network, click **Connect** and enter the password when prompted.

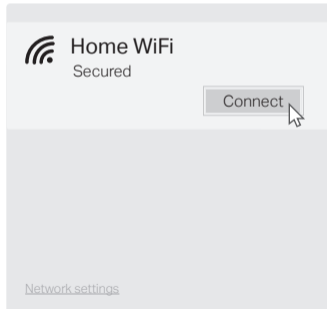

## Troubleshooting

If you have problems during the installation, please refer to the following online FAQs.

**T1. Check if the Driver is Successfully Installed:**

<https://www.mercusys.com/faq-262>

**T2. Can't Install the Driver in the Windows Systems:**

<https://www.mercusys.com/en/faq-817>

**T3. Can't Find the Hardware Version of the Adapter:**

<https://www.mercusys.com/en/faq-813>

**T4. How to Manually Install / Update Adapters on Windows 10:** <https://www.mercusys.com/faq-265>

## Safety Information



- Do not attempt to disassemble, repair, or modify the device. If you need service, please contact us.
- Do not use the device where wireless devices are not allowed.
- Keep the device away from water, fire, humidity or hot environments.
- This product can be powered only by power supplies that comply with Power Source Class 2(PS2) or Limited Power Source(LPS) of IEC 62368-1.

Mercusys hereby declares that the device is in compliance with the essential requirements and other relevant provisions of the Radio Equipment Regulations 2017. The original UK declaration of conformity may be found at <https://www.mercusys.com/support/ukca/>

Mercusys hereby declares that the device is in compliance with the essential requirements and other relevant provisions of directives 2014/53/EU, 2011/65/EU and (EU) 2015/863.

The original EU declaration of conformity may be found at <https://www.mercusys.com/en/ce>



## Support

For technical support, user guides, the driver and more information, please visit <https://www.mercusys.com/support>.